

The ABAWD time limit

Presentation by:

Jared Call, California Food Policy Advocates and
Jessica Bartholow, Western Center on Law and Poverty

Hosted by:

Edith Martinez, California Association of Food Banks



June 21, 2018

Welcome!

Webinar Logistics

Webinar will be recorded and will be part of a CalFresh Outreach ABAWD toolkit

Got Questions?

Type them in the question pane on your control panel

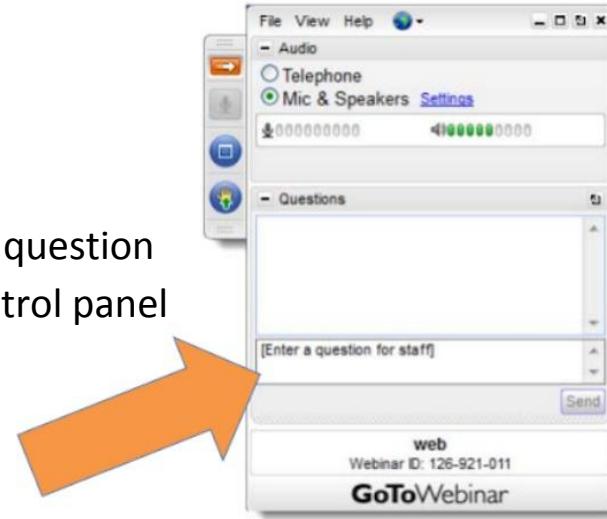

Agenda

1. **Overview:** Why does this matter?
2. **ABAWD basics:** What should I know?
3. **Outreach toolkit:** What resources do I have?
4. **Q&A**

1.

OVERVIEW

Why does this matter?



Who is subject to the Three-Month Time Limit? Able-Bodied Adults Without Dependents

Definition

- Between 18 and 49 years old
- Not disabled
- Not living with children
- Not otherwise “exempt”

Characteristics

- Very poor** with average income under 20% of FPL
- Not eligible for many other public benefits (CalFresh may be the only assistance they get)
- Ohio Association of Food Banks Report:
 - 1 in 3 face significant barriers to employment (language, undiagnosed mental health issues, criminal record)
 - Requires individual assessment of situation, barriers, and skills

CalFresh is CA's first line of defense against hunger

With the loss of CA's statewide ABAWD waiver, people with ABAWD status are only eligible for benefits for three full months out of a 36 month period unless they are exempt or meet the work requirement

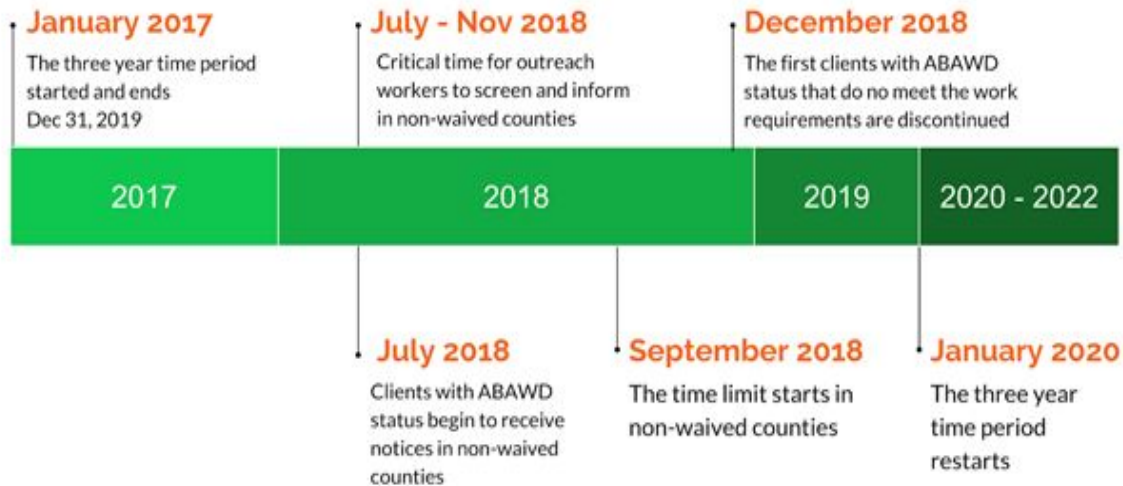

Other States Have Struggled to Implement the Rule

- Unable to identify ABAWDs early enough or accurately.
- Not all work, training and exemptions are captured.
- Peoples' circumstances change.
- Individuals must self-assess and obtain verification.
- Few qualifying activities are available.
- Notices and forms are confusing and inaccurate.
- Bottom line: Eligible individuals lose SNAP, often without knowing what happened.

Caseloads declined drastically in states where time limit newly imposed

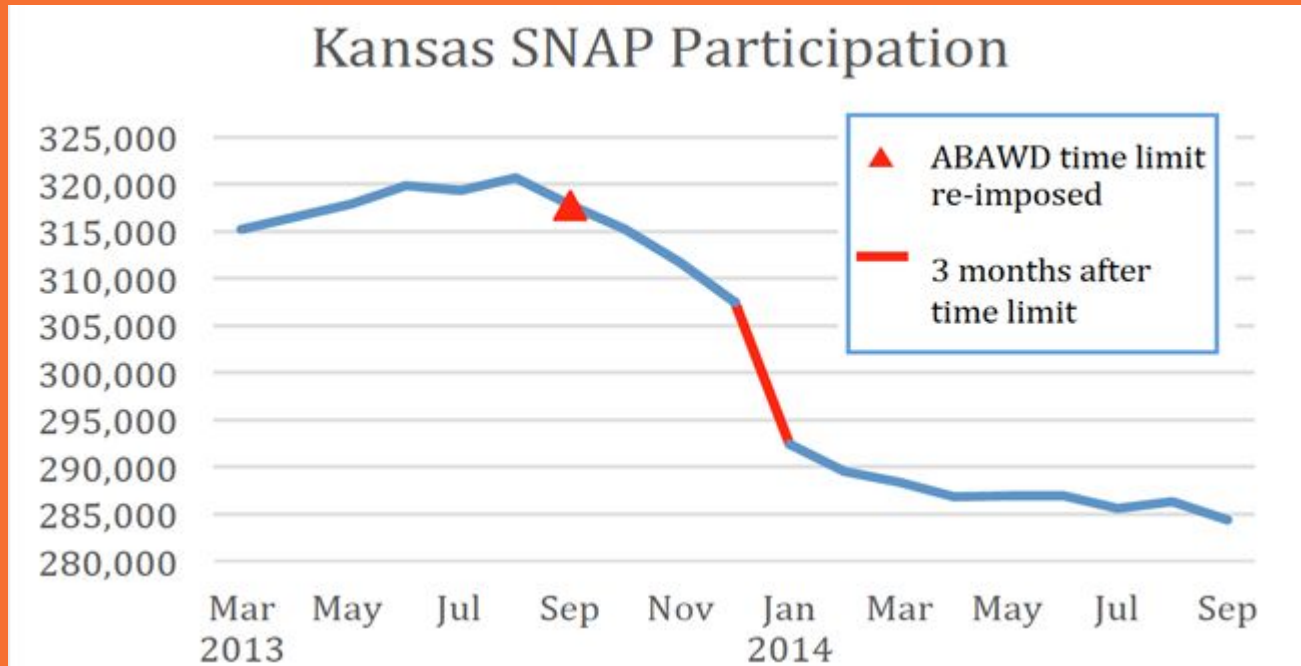

A group of people are seated around a table in what appears to be a meeting or workshop. The image is overlaid with a semi-transparent green filter. In the center, white text reads: "Outreach workers will play an important role in helping people maintain and access CalFresh benefits". The people are engaged in conversation, with some looking towards the center and others looking at documents on the table. A man with glasses is on the left, and a woman with long blonde hair is in the middle. A person in a plaid shirt is seen from the back in the foreground.

Outreach workers will play an important role
in helping people maintain and access
CalFresh benefits

Key Issues for Application Assisters

- Knowing County waiver status
- Supporting Effective County Screening
- Identifying ABAWDs Prior & Post
- Helping ABAWDs Keep or Restore Benefits
- Informing the Community

Words Matter

People first
language is
the standard

Outreach workers can decrease stigma and help people self-identify by being mindful of the words they use



Words/phrases to avoid

ABAWDs

Unfit for work



Preferred words/phrases

People with ABAWD status

Unable to work 80 hours per
month

Informing and Educating Clients

URGENT

**MANHATTAN RESIDENTS:
ARE YOU 18-49 YEARS OF AGE?
YOUR SNAP BENEFITS MAY HAVE TIME LIMITS!**

Starting April 1st, many unemployed New Yorkers living on or below West 110th or East 96th Street will lose their SNAP Benefits

YOU MAY BE EXEMPT IF YOU ARE:

- Unable to work for at least 80 hours per month due to a physical or mental limitation, ill or injured

APRIL 2016

**SNAP 3-Month Time Limit:
What You Need to Know**

Beginning January 1, 2016, the federal SNAP time limit for able-bodied adults without dependents (ABAWDs) went back into effect in Pennsylvania. The time limit does not apply to many counties in Pennsylvania.

As of January 1, 2016, an ABAWD can only get 3 full months of SNAP in a 36-month period—unless s/he lives in a **waived part of PA**, meets an **exemption**, or is meeting certain hours in **qualifying work activities**. To see a list of waived areas in Pennsylvania, visit <https://cisphila.org/abawds>.

If you are getting letters from the Department of Human Services (DHS) about ABAWD requirements, check below to see if you can be found exempt or, if not, how to meet the work requirements. Follow the **Action** item to make sure you can keep your SNAP benefits.

Who is exempt?

3-month SNAP limit does not apply if you meet any of the following:

ATTENTION!

Rules for the Food Supplement Program (FSP/SNAP, formerly food stamps), which helps low-income Marylanders buy food, have changed effective January 1, 2016

Under federal law, "able bodied adults without dependents" (ABAWDs) can only get FSP benefits for a **maximum of 3 months** in a 3 year period unless they are exempt or participating in an approved work activity.

People that may be affected are:

- Living in Anne Arundel, Baltimore, Carroll, Frederick, Howard, Montgomery, Prince George's and Washington Counties

Between the ages of 18-49

Outreach Partners Can Help Identify Exempt Clients

SNAP ABAWD Time Limit Checklist

The federal SNAP time limits for able-bodied adults without dependents (ABAWDs) went back into effect January 1, 2016 in Massachusetts. An ABAWD is someone between the ages of 18 and 49 who is not disabled, pregnant or living with minor children.

An ABAWD can only get 3 full months of SNAP in a 36-month period—unless s/he lives in a **waived part of MA**, meets an **exemption**, or is meeting certain hours in **qualifying work activities**.

If a SNAP recipient is getting letters from DTA about ABAWD requirements, check below to see if they are exempt or, if not, how to meet the work requirements. Follow the corresponding Client Action item to make sure SNAP benefits will not be interrupted.

Exemptions

- Under age 18 or 50 and older

CLIENT ACTION → DTA has already exempted ABAWDs based on age. DTA should know when people turn 50 and become exempt. If you turn 50, call DTA to keep your SNAP or to get back on.

- Physically or mentally unable to work 20 hours per week

Many ABAWDs are not actually “able-bodied,” but DTA may not know if the person does not get a disability benefit. An ABAWD can be exempt from the three month time limit if s/he has a physical or mental condition that “reduces their ability to work.” Being determined to be unfit for work has a much lower standard of unfitness than SSI and does not require a specific diagnosis or submission of medical test results.

CLIENT ACTION → Have a health care provider fill out DTA’s **ABAWD medical report form**. It can be signed by many health care providers, including:

- Doctor, doctor’s assistant or representative of a doctor’s office
- Nurse practitioner
- Licensed or certified psychologist
- Licensed social worker
- Osteopath
- Certified mental health counselor
- Certified midwife

Special Outreach to Medical Providers

Provider Network Fax Blast
Monday, December 21, 2015



Provider Notification

You Can Help Low-Income Single Adults Keep their Food Benefits

SNAP benefits (formerly food stamps) allow low-income people to buy the food they need to stay healthy. Many patients and CeltiCare Health members (single adults ages 18-50) are considered Able-bodied Adults Without Dependents (ABAWDs). **They are at risk of losing their SNAP benefits** (food stamps) because of a reinstated federal rule that goes into effect on January 1, 2016. The rule limits SNAP benefits to 3 months in a 3 year period - unless your patient meets an exemption or certain work rules.

With just a few minutes of your time, we can easily help. Many ABAWDs may be homeless, lacking regular health care, disabled or unable to work. If you are working with a patient who fits this description, you can easily help him or her in the following ways:

- If the patient is **homeless**, you can help the patient call the Department of Transitional Assistance

Top Outreach Messages (from Oregon)

New time limits may affect you. Connect with your County CalFresh office to learn more.

- Connect with County to learn if the time limits affect you

Report exemptions

- Connect with County to report if you meet an exemption

You can still fix things in December 2018

- If you do nothing your benefits may be affected at the beginning of December, but you can still restore benefits by connecting with your County to report an exemption or to meet work requirements (counting months can be removed)

2.

ABAWD BASICS

What should I know?



Who has ABAWD status?

A person between the ages of 18 – 49,
receiving CalFresh but not CalWORKs,
who is able-bodied
and not living with a minor.

An adult with ABAWD status may or may not have a time
limit.

Major changes



1. All counties must identify CalFresh recipients with ABAWD status and report it to CDSS.



2. In certain counties adults with ABAWD status will have to meet the work requirement OR an exemption to be able to receive CalFresh for more than three months in a three year time period.

Exemptions

1. Living in an area with a geographic waiver
2. Pregnancy (any trimester)
3. Participating in an Office of Refugee Resettlement Training Program
4. Physically or mentally unable to work for 80 hours a month (subcategories apply)
5. Exempt from CalFresh work registration requirements (subcategories apply)

Exemptions continued:

Physically or mentally unable to work for 80 hours a month

1

Applied/receiving temporary or permanent public or private disability benefits

2

Obviously unable to work based on eligibility worker observation/judgement

3

Medically certified as unable to work for 80 hours a month

4

Determined unable to work after a screening and finding of chronic homelessness

5

Determined unable to work after a screening and finding that they have a alcohol or drug addiction

6

Determined unable to work after a screening and finding that they are escaping domestic violence

Exemptions continued:

Exempt from CalFresh work registration requirements

1

Responsible for taking care of an incapacitated person

2

Applied for or receiving unemployment insurance benefits

3

Receiving weekly earnings (from a job or self-employment) equal to or greater than the federal minimum wage multiplied by 30 hours

4

Migrant or seasonal farm workers to begin work in the next 30 days, who will work 30hrs/week OR earn the equivalent to the federal minimum wage multiplied by 30 hours

5

Enrolled in school, training program or institution of higher education on at least a half time basis

The 15% Exemption

- States receive a number of “individual exemptions” equal to 15 percent of the statewide caseload with ABAWD status, therefore referred to as the “15 percent exemption.”
- Each 15% exemption = 1 month of CalFresh benefits for 1 adult with ABAWD status.
- CDSS informs each county how many of these exemptions each county has via an annual All County Information Notice (ACIN).
- CDSS suggested uses include:
 - Overissuance protection
 - Individual falls short of meeting work requirement
 - Individual is re-entering the community from prison/jail or has a criminal record
 - Dependent child turning 18
 - Seasonally employed

Work
Requirement:
3 options

Work

Employment, self-employment, in-kind work

Work activities

Community service, some E & T components, programs under WIOA and the Trade Act

Workfare

Number of hours required based on CalFresh benefit amount

3.

OUTREACH TOOLKIT

What resources are
available?



ABAWD Outreach Toolkit Components

Tools

1. Guidebook
2. Talk points for outreach workers
3. Flowchart to determine if time limit applies
4. Paper screener to help determine ABAWD status and time limit
5. Excel screener
6. Verifications chart
7. Client form to collect information necessary to determine ABAWD status
8. Client FAQs
9. Application assistance receipt
10. ABAWD webinar (recording)

Q&A

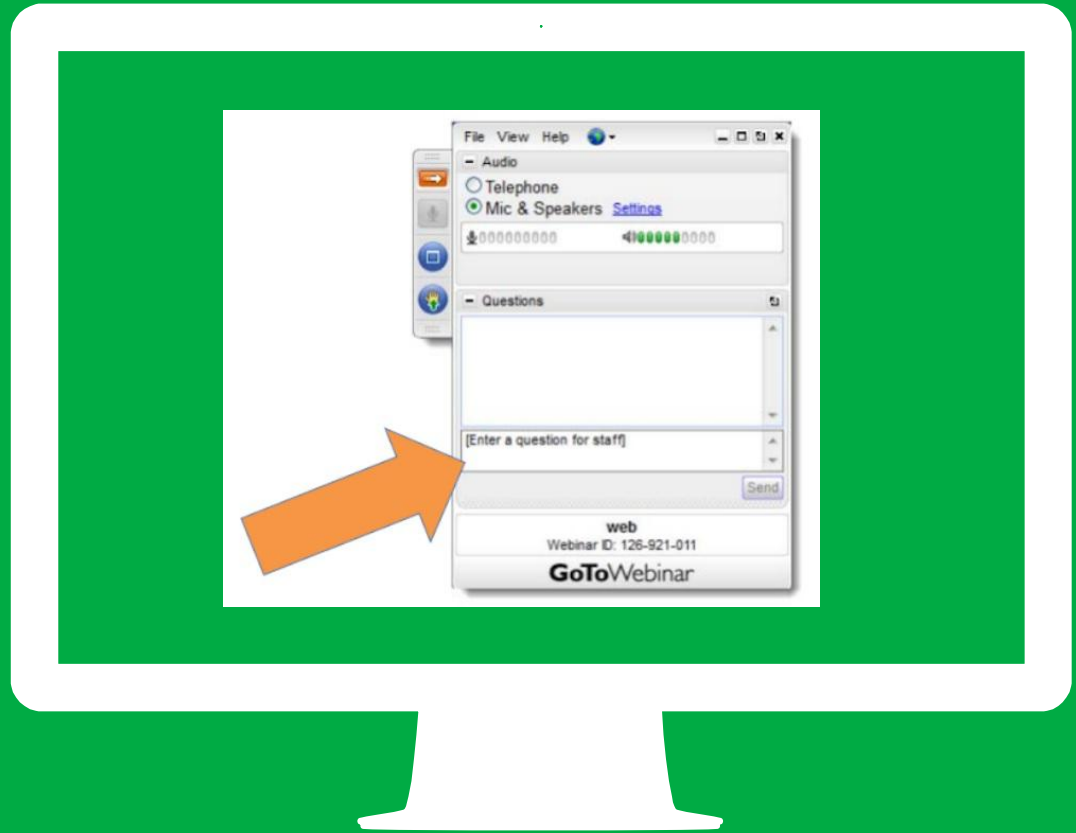

Thank you!